



HANGCHA GROUP CO., LTD.

Factory site: 666 Xiangfu Road,
Hangzhou, Zhejiang, China (311305)

Tel: +86-571-88926735 88926755
Fax: +86-571-88926789 88132890

sales@hcforklift.com
www.hcforklift.com



Follow us on
Facebook



Follow us on
YouTube



Follow us on
WeChat



Download "Hangcha
Forklift" App



ISO14001
2015



ISO9001
2015



HANGCHA trucks conform
to the European Safety
Requirements.

HANGCHA GROUP CO., LTD. reserves the right to make any changes without notice concerning colors, equipment, or specifications detailed in this brochure, or to discontinue individual models. The colors of trucks, delivered may differ slightly from those in brochures.

2025 VERSION 2/COPYRIGHT 2025/11

X Series 3/4 Empty Container Handler

with capacities of 6,000 to 7,000kg



The World of Hangcha
SINCE 1956





Appearance

/ Professional exterior industrial design, high-end product with high identification, compact and smooth style showing modern industrial aesthetics. Hidden arrangement. The exposed part allows more clean and neat appearance.

Comfort

/ Excellent all round visibility is achieved by the overall design. Meanwhile, the advanced, low-noise, ergonomic control arrangement and the standard cab with cooling and heating air conditioner improve the driving comfort, and can meet the driver's needs for long time and high intensity operation, no matter it is in summer or winter.



Suspended seat with fingertip system that can be easily adjusted to suit each customer.



Intelligent

/ The central controller of the forklift uses CAN bus architecture to monitor the built-in diagnostic sensors, manage the functions of the forklift and raise central fault alarm of the forklift. /Optional intelligent management system can be selected to make remote intelligent monitoring manage devices more easily.



Optional imaging system with front and rear camera, increasing the safety greatly.

Maintainability

/ The whole vehicle is equipped with a tiltable cab, a wide-opened hood, mast centralized lubrication and fault diagnosis display function, which is very convenient for maintenance.
/ Battery compartment is easy to open for easy maintenance.

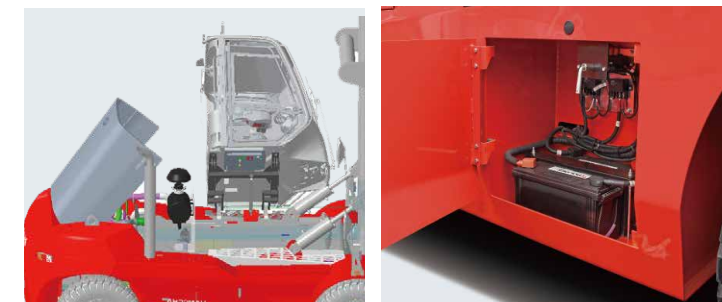

Fully-suspended all-round vision cab

The new fully-suspended all-round vision cab (HPC) and optimized vehicle outline enable all-round sight and view. Performance of the air conditioner is improved to enable uniform conditioned air blowing from the air outlet and a strong cooling effect. The waterproof, dust-proof, heatproof, soundproof, noise-reducing sealing design improves driving comfort. The molded interior parts enable a more comfortable feel. The integral frame is constituted by profiled steel pipes. The structural parts have higher strength.



Reliable

- / The adoption of famous-brand engine, transmission and drive axle, and the parts subject to verification for many years achieve stable quality and high reliability.
- / Safety control functions such as over-speed alarm, overload alarm and descending buffer can be configured to ensure operation safety.
- / The adoption of the spreader of an internationally renowned brand brings a higher reliability, a longer service life, a lower failure rate and a lower maintenance cost.
- / Heavy-duty traction axle, two-stage deceleration; Wet brake, maintenance-free; Hydraulic release spring action parking brake, safe and reliable.

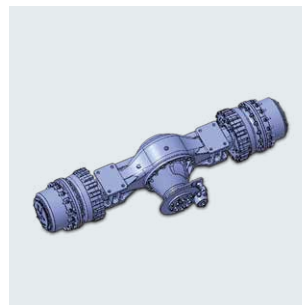
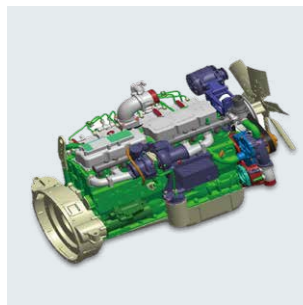

OKAMURA gear box with micro-electronic control provides for two-shift power shifting, travelling is stable and accurate.



STAGE V & TIER 4F

HANGCHA with you at every stage

Efficient, reliable solutions for your demands

With Hangcha you can meet all Stage V/Tier 4f emissions standards which provides customer demands for value, innovation and performance. The technologies include common rail fuel systems, Turbocharged Inter-cooled selective catalytic reduction (SCR), diesel oxidation catalysts (DOC) and diesel particulate filters (DPF). Designed and optimised to every engine model, our forklift truck maximises efficiency and reliability.

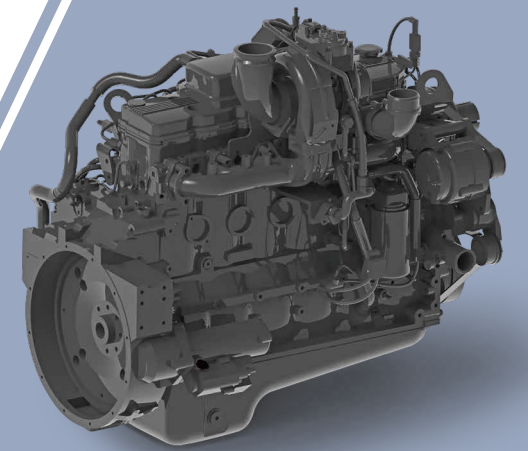

CUMMINS B6.7



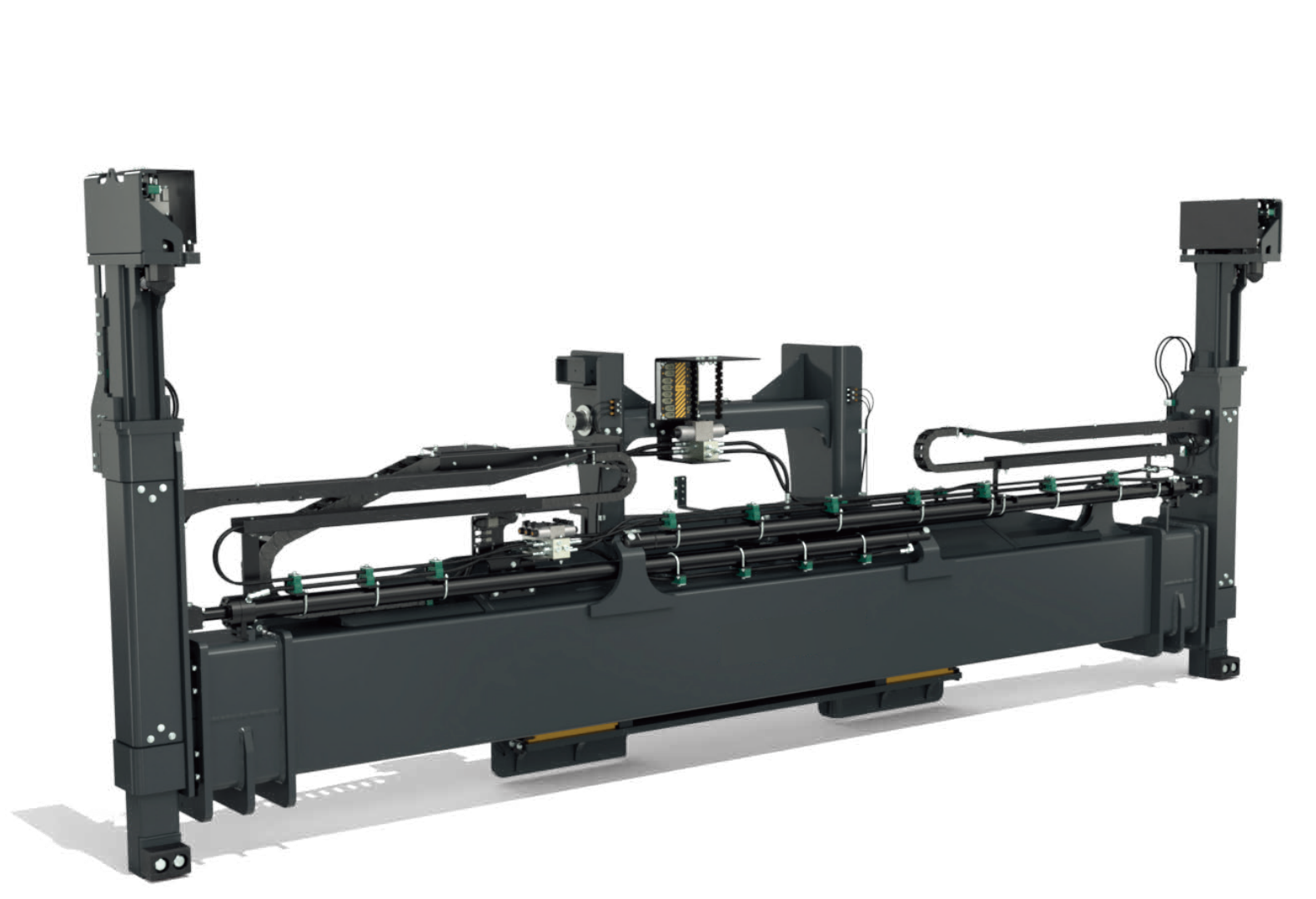

Single handling container spreader Vertical Twistlocks.



Improved design with built-in cabling and larger bending radius for hydraulic hose between pocket and end-post.



Suitable for:
/ 20' or 40' ISO containers of 8' (2.44 m) width.
/ Approx. 2.45-2.50 m wide "pallet-wide" 20' or 40' containers, with ISO-like 'chamfered' corner castings.
/ With speed limitation for laden/unladen.

Not suitable for:
/ Approx. 2.45 - 2.60 m wide "CPC" containers (Cellular Pallet-wide Containers) with non-ISO corner castings.

TECHNICAL SPECIFICATIONS	
Type of lifting system	Two vertical twistlocks
Type of stacking	Normal and block stacking
Spreader weight (TW)	3600kgs
Carriage weight (MPS)	1050kgs
Lifting capacity (SWL)	6-7tonnes
Telescopic positions	20 and 40ft
Telescoping speed, 20-40ft	< 12sec.*
Telescoping speed, 40-20ft	< 14sec.*
Sideshift	± 600
Mechanical pile slope (MPS), vertical floating end-posts	At 20ft position: approx. 200mm At 40ft position: approx. 200mm
Hydraulics, operating pressure up to	140bar
Hydraulics, flow	40-60L/min
Electric - control voltage	24VDC
Communication	CAN 2.0B
Colour	Black grey RAL 7021

* Calculated speed at 60 L/min



Features

Transmission	Standard	Options
Pneumatic tyre	●	
Solid smooth tire		○
Steering system		
Fully hydraulic power steering	●	
Centralized lubrication system (machine)	●	
Automatic Lubrication System		○
Power system		
Extended exhaust pipe	●	
Lockable fuel cap		○
Spark arrester		○
Pre-cleaner air filter	●	
Truck		
Tow pin	●	
Electrostatic discharge chain		○
Rear-view mirror on right & left mudguards	●	
Operating system		
Integrated joystick	●	
Adjustable steering column	●	
Adjustable armrest	●	
Hydraulic system		
Operation proportion control	●	
Cab		
Cabin	●	
Climate control system (air-conditioning and heater)	●	
Manual tilting cabin	●	
Electric tilting cabin		○
Radio	●	
Sunshade	●	
USB charging interface	●	
Clothes hanger hook	●	
Reading light	●	
1 x 24V power supply		○
1 x 12V power supply		○
License plate frame		○
Fan	●	
Lifting components		
Duplex mast	●	
Standard lifting height	●	
Optional lifting height		○
Spreader & twistlock double protection	●	
Twistlock counter		○
2 x Spreader twistlock light	●	
Emergency descent	●	
Other		
Standard color	●	
User defined colour		○
Fire extinguisher (2kg/4kg)		○
Vehicle toolkit	●	
Mast automatic vertical realignment		○
Lifting height indicator on display		○
Dynamic speed Limit depending of lift height(customer defined)		○
Heating pack for the cold region		○
FIMS(Fleet intelligent management system)	●	

Electrical System	Standard	Options
Operator Presense System (OPS) with buzzer	●	
LCD display screen	●	
Main power switch	●	
Emergency power off switch	●	
Maintenance-free 24V lead acid battery	●	
Reverse buzzer	●	
High decible horn	●	
LED lights (entire vehicle)	●	
2 x Working light on front mudguard	●	
2 x Front working light on top of cabin	●	
2 x Rear working light on top of cabin	●	
2 x Working light on both sides of mast	●	
Reverse sensor	●	
Rearview camera system	●	
Rearview camera system with memory		○
Front & rearview camera system		○
Front & rearview camera system with memory		○
4 directions camera system with single display		○
4 directions camera recording system with single display		○
In cabin CCTV		○
Rear blue safety light		○
Front and rear blue safety light		○
Three sided blue danger zone light		○
Overspeed alarm		○
Voice reverse alarm		○
Automatic fire suppression system		○
Two-way radio		○
Weight indicator in display		○
Flashing warning light (non rotating) with control switch	●	
Tyre pressure monitoring		○
On-board diagnostics system	●	
Override switch	●	
Engine fault alarm	●	
Engine oil pressure alarm indicator	●	
Air filter warning indicator	●	
Water temperature indicator	●	
Hour meter	●	
Battery charge indicator	●	
Low hydraulic pressure alarm indicator	●	
Hydraulic oil filter warning indicator	●	
Oil gauge	●	
Fuel-water separator warning indicator	●	
Oil temperature gauge	●	
Pre-heat indicator	●	
Drive mode indicator	●	
Parking brake indicator	●	
Service indicator	●	